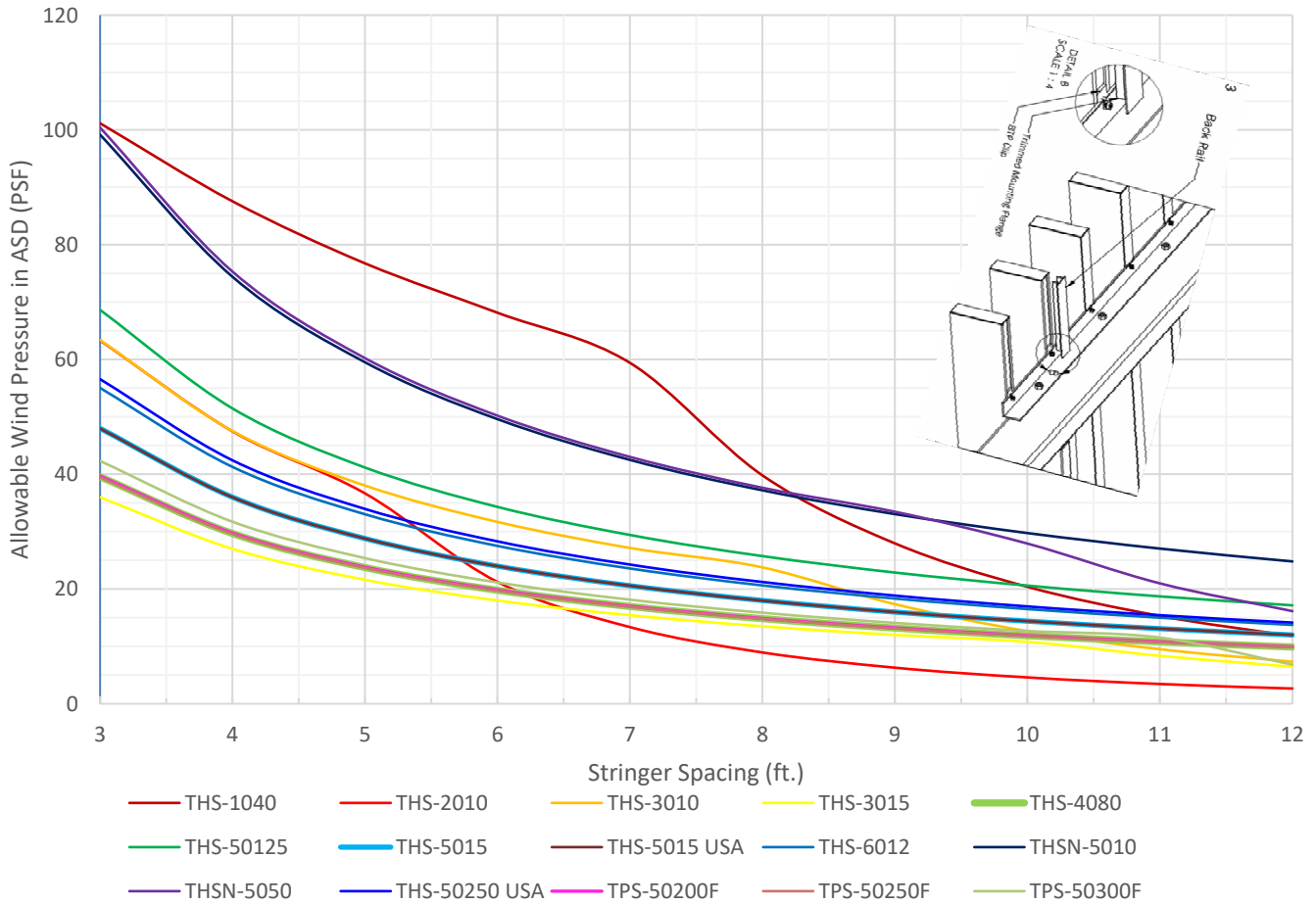

FIGURE L1: VERTICAL LOUVERS TO HORIZONTAL STRINGER



Assumptions

- This chart displays vertical extrusion installation with horizontal support stringers (Assumes continuous span, min 3 bays)
- Capacities Assume the Following
 - Horizontal stringer connections back to structure at 16 " o.c.
 - Louvers spaced no closer than 3 " o.c. for all extrusions other than THS-1040 then 6 " o.c.
 - No opinion is given to capacity of connection of stringer to structure or structure capacity
 - These capacities apply to full assembly of Louvers and Stringers STAL-7, STAL-8
 - Attachment of Stringer to Structure Capacity may govern design and should be investigated.

Capacity per connections Graphs (C1, C2) Tables (T1, T4, T5)

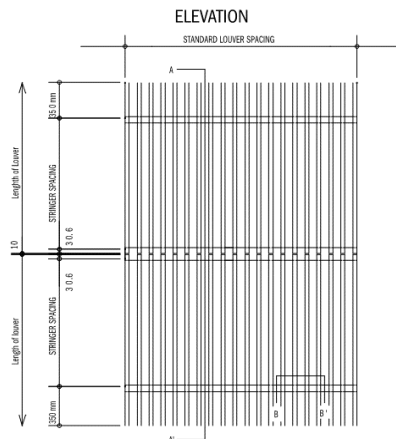

VL - Vertical Louver
HS - Horizontal Stringer

13228 NE 20th St., Suite 100, Bellevue, WA 98005 | (425) 614-0949

Project: B&N Industries Aluminum Extrusion Load Tables
Address: Anywhere, USA
Client: B&N Industries

Pg. No: B - 1
Date: 4/16/24
Job No.: 23374



Calculation: Tables Vertical Louver {1-3}

TABLE T1: VERTICAL LOUVERS HORIZONTAL STRINGER

	Stinger Spacing (ft.)	3	4	5	6	7	8	9	10	11	12
THS-1040		101	88	77	68	59	40	28	20	15	12
		Stringer	Stringer	Stringer	Stringer	Deflection	Deflection	Deflection	Deflection	Deflection	Deflection
THS-2010		63	47	37	21	13	9	6	5	3	3
		Flat Plate	Flat Plate	Deflection	Deflection	Deflection	Deflection	Deflection	Deflection	Deflection	Deflection
THS-3010		63	48	38	32	27	24	17	13	10	7
		Flat Plate	Flat Plate	Flat Plate	Flat Plate	Flat Plate	Flat Plate	Deflection	Deflection	Deflection	Deflection
THS-3015		36	27	22	18	15	14	12	11	8	6
		Flat Plate	Flat Plate	Flat Plate	Flat Plate	Flat Plate	Flat Plate	Flat Plate	Flat Plate	Deflection	Deflection
THS-4080		40	30	24	20	17	15	13	12	11	10
		Flat Plate	Flat Plate	Flat Plate	Flat Plate	Flat Plate	Flat Plate	Flat Plate	Flat Plate	Flat Plate	Flat Plate
THS-50125		69	51	41	34	29	26	23	21	19	17
		Flat Plate	Flat Plate	Flat Plate	Flat Plate	Flat Plate	Flat Plate	Flat Plate	Flat Plate	Flat Plate	Flat Plate
THS-5015		48	36	29	24	21	18	16	14	13	12
	Pressure (PSF)	Flat Plate	Flat Plate	Flat Plate	Flat Plate	Flat Plate	Flat Plate	Flat Plate	Flat Plate	Flat Plate	Flat Plate
THS-5015 USA	[ASD]	48	36	29	24	21	18	16	14	13	12
	[Failure Mode]	Flat Plate	Flat Plate	Flat Plate	Flat Plate	Flat Plate	Flat Plate	Flat Plate	Flat Plate	Flat Plate	Flat Plate
THS-6012		55	41	33	28	24	21	18	17	15	14
		Flat Plate	Flat Plate	Flat Plate	Flat Plate	Flat Plate	Flat Plate	Flat Plate	Flat Plate	Flat Plate	Flat Plate
THSN-5010		99	74	60	50	43	37	33	30	27	25
		Flat Plate	Flat Plate	Flat Plate	Flat Plate	Flat Plate	Flat Plate	Flat Plate	Flat Plate	Flat Plate	Flat Plate
THSN-5050		100	75	60	50	43	38	33	28	21	16
		Flat Plate	Flat Plate	Flat Plate	Flat Plate	Flat Plate	Flat Plate	Flat Plate	Deflection	Deflection	Deflection
THS-50250 USA		57	42	34	28	24	21	19	17	15	14
		Flat Plate	Flat Plate	Flat Plate	Flat Plate	Flat Plate	Flat Plate	Flat Plate	Flat Plate	Flat Plate	Flat Plate
TPS-50200F		40	30	24	20	17	15	13	12	11	10
		Flat Plate	Flat Plate	Flat Plate	Flat Plate	Flat Plate	Flat Plate	Flat Plate	Flat Plate	Flat Plate	Flat Plate
TPS-50250F		39	30	24	20	17	15	13	12	11	10
		Flat Plate	Flat Plate	Flat Plate	Flat Plate	Flat Plate	Flat Plate	Flat Plate	Flat Plate	Flat Plate	Flat Plate
TPS-50300F		42	32	25	21	18	16	14	13	12	7
		Flat Plate	Flat Plate	Flat Plate	Flat Plate	Flat Plate	Flat Plate	Flat Plate	Flat Plate	Flat Plate	Stringer



13228 NE 20th St., Suite 100, Bellevue, WA 98005 | (425) 614-0949

Project:	B&N Industries Aluminum Extrusion Load Tables	Pg. No: B - 2
Address:	Anywhere, USA	Date: 4/16/24
Client:	B&N Industries	Job No.: 23374

FIGURE L7: VERTICAL LOUVERS TO HORIZONTAL STRINGER

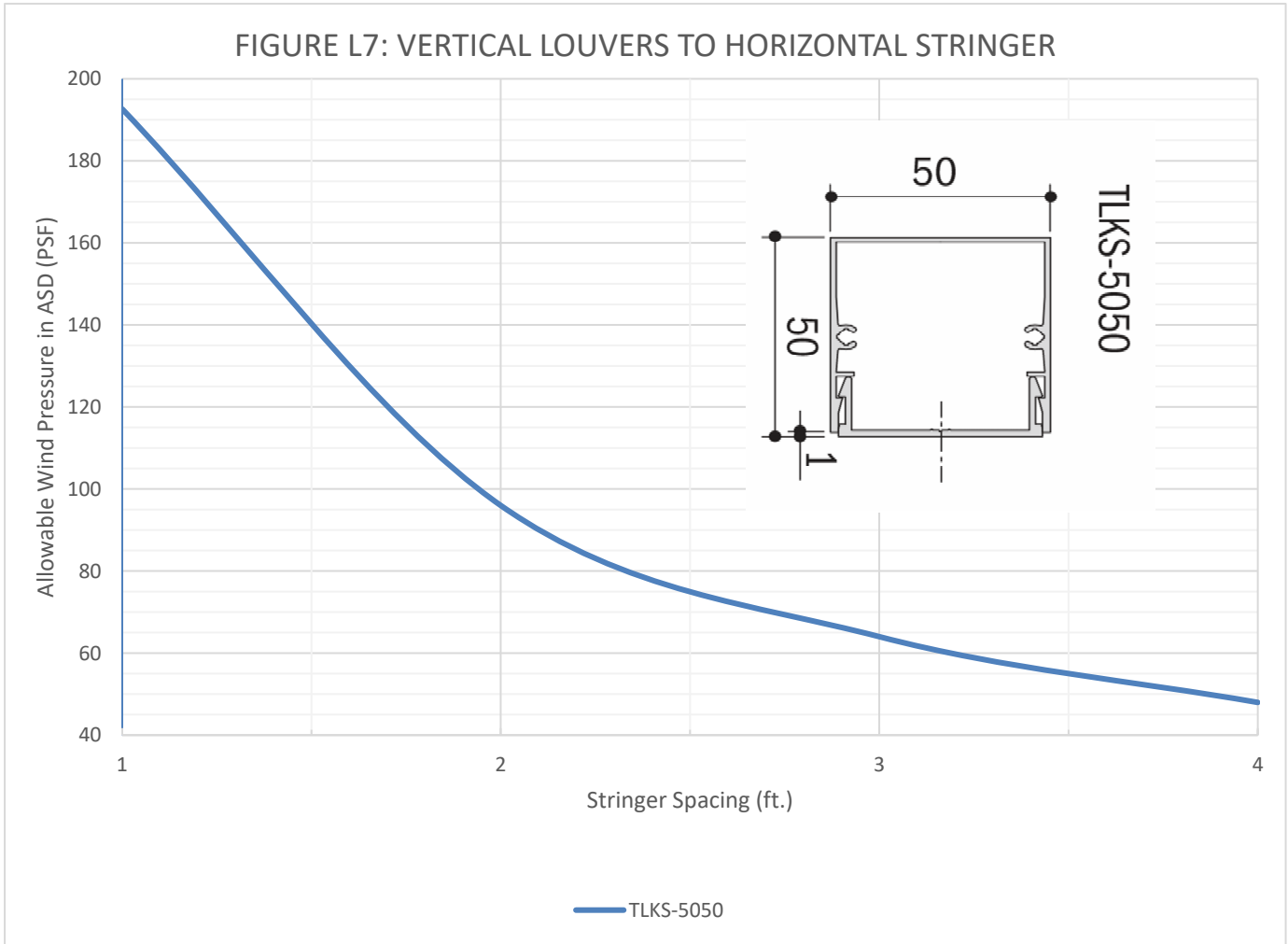
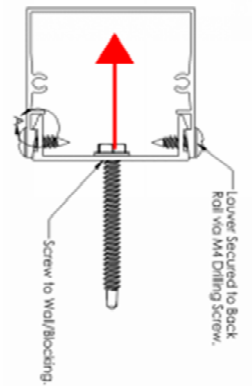

TABLE T7: VERTICAL LOUVERS HORIZONTAL STRINGER

	Stringer Spacing (ft.)	1	2	3	4
TLKS-5050	Pressure (PSF) [ASD]	193	96	64	48
		Flat Plate	Flat Plate	Flat Plate	Flat Plate
	Max Reaction Tension (lbs)	39	39	39	39
	Max Reaction Shear (lbs)	39	39	39	39



13228 NE 20th St., Suite 100, Bellevue, WA 98005 | (425) 614-0949

Project: B&N Industries Aluminum Extrusion Load Tables
 Address: Anywhere, USA
 Client: B&N Industries

Pg. No: B - 3
 Date: 4/16/24
 Job No.: 23374

FIGURE L2: HORIZONTAL LOUVERS TO HORIZONTAL STRINGER

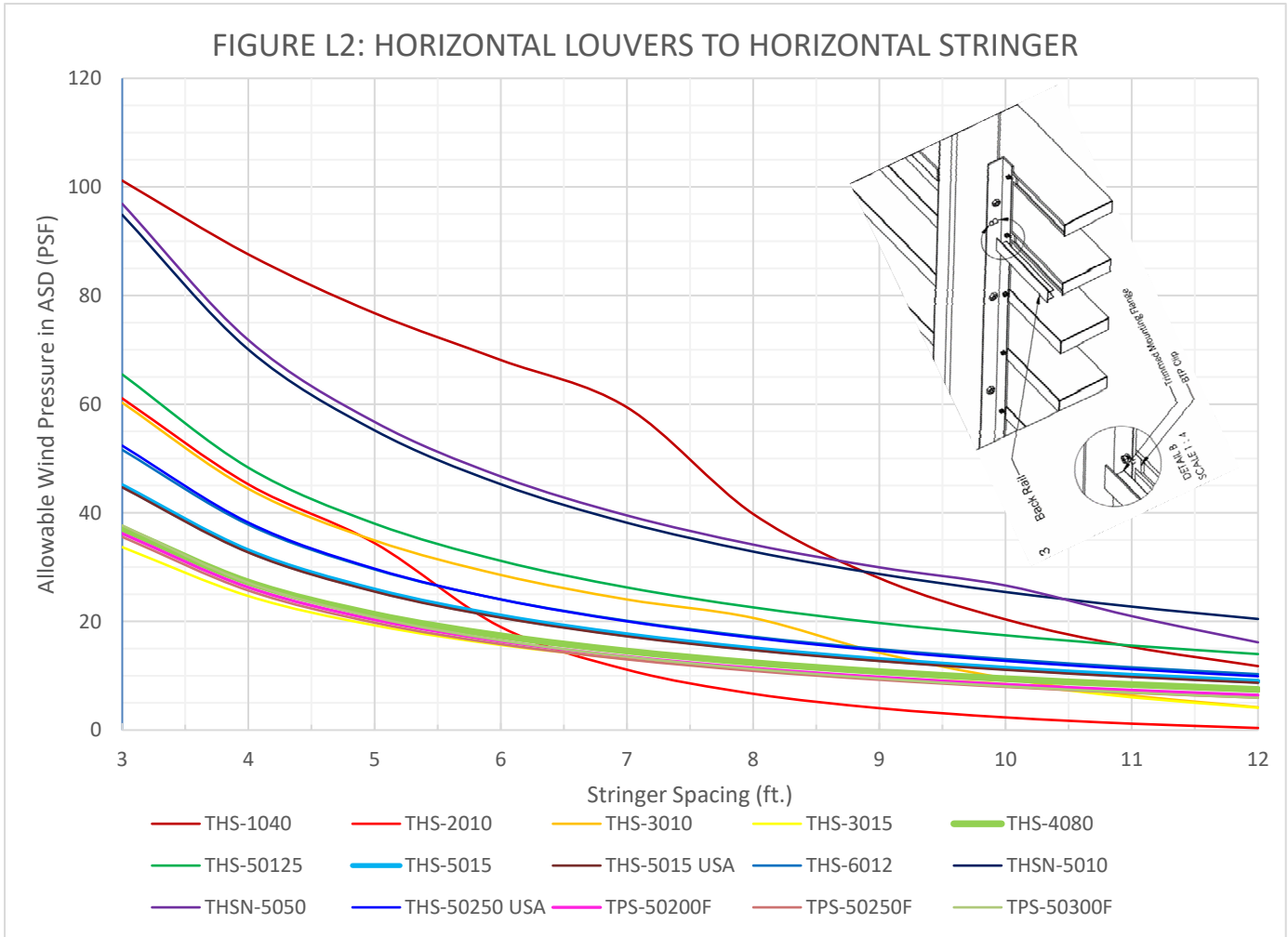

Assumptions

- This chart displays vertical extrusion installation with vertical support stringers (Assumes continuous span, min 3 bays)
- Capacities Assume the Following
 - Vertical stringer connections back to structure at 16 " o.c.
 - Louvers spaced no closer than 3 " o.c. for all extrusions other than THS-1040 then 6 " o.c.
 - No opinion is given to capacity of connection of stringer to structure or structure capacity
 - These capacities apply to full assembly of Louvers and Stringers STAL-7, STAL-8
 - Attachment of Stringer to Structure Capacity may govern design and should be investigated. VL - Vertical Louver
HS - Horizontal Stringer

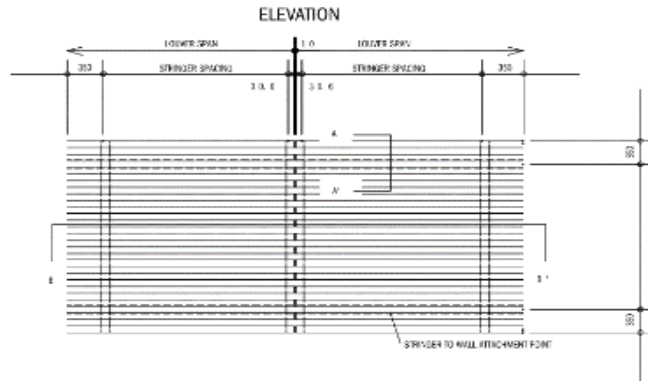

HL - Horizontal Louver
VS - Vertical Stringer



13228 NE 20th St., Suite 100, Bellevue, WA 98005 | (425) 614-0949

Project:	B&N Industries Aluminum Extrusion Load Tables	Pg. No:	B - 4
Address:	Anywhere, USA	Date:	4/16/24
Client:	B&N Industries	Job No.:	23374

Calculation: Tables Horizontal Louver {4-6}

TABLE T2: HORIZONTAL LOUVERS VERTICAL STRINGER

	Stinger Spacing (ft.)	3	4	5	6	7	8	9	10	11	12
THS-1040		101	88	77	68	59	40	28	20	15	12
		Stringer	Stringer	Stringer	Stringer	Deflection	Deflection	Deflection	Deflection	Deflection	Deflection
THS-2010		61	45	34	19	11	7	4	2	1	0
		Flat Plate	Flat Plate	Deflection	Deflection	Deflection	Deflection	Deflection	Deflection	Deflection	Deflection
THS-3010		60	44	35	29	24	21	14	10	6	4
		Flat Plate	Flat Plate	Flat Plate	Flat Plate	Flat Plate	Flat Plate	Deflection	Deflection	Deflection	Deflection
THS-3015		34	25	19	16	13	11	10	8	6	4
		Flat Plate	Flat Plate	Flat Plate	Flat Plate	Flat Plate	Flat Plate	Flat Plate	Flat Plate	Deflection	Deflection
THS-4080		37	27	21	17	15	12	11	9	8	7
		Flat Plate	Flat Plate	Flat Plate	Flat Plate	Flat Plate	Flat Plate	Flat Plate	Flat Plate	Flat Plate	Flat Plate
THS-50125		65	48	38	31	26	23	20	17	16	14
		Flat Plate	Flat Plate	Flat Plate	Flat Plate	Flat Plate	Flat Plate	Flat Plate	Flat Plate	Flat Plate	Flat Plate
THS-5015		45	33	26	21	18	15	13	11	10	9
	Pressure (PSF)	Flat Plate	Flat Plate	Flat Plate	Flat Plate	Flat Plate	Flat Plate	Flat Plate	Flat Plate	Flat Plate	Flat Plate
THS-5015 USA	[ASD]	45	33	25	21	17	15	13	11	10	9
	[Failure Mode]	Flat Plate	Flat Plate	Flat Plate	Flat Plate	Flat Plate	Flat Plate	Flat Plate	Flat Plate	Flat Plate	Flat Plate
THS-6012		52	38	30	24	20	17	15	13	12	10
		Flat Plate	Flat Plate	Flat Plate	Flat Plate	Flat Plate	Flat Plate	Flat Plate	Flat Plate	Flat Plate	Flat Plate
THSN-5010		95	70	55	45	38	33	29	25	23	20
		Flat Plate	Flat Plate	Flat Plate	Flat Plate	Flat Plate	Flat Plate	Flat Plate	Flat Plate	Flat Plate	Flat Plate
THSN-5050		97	72	57	47	40	34	30	27	21	16
		Flat Plate	Flat Plate	Flat Plate	Flat Plate	Flat Plate	Flat Plate	Flat Plate	Flat Plate	Deflection	Deflection
THS-50250 USA		52	38	30	24	20	17	15	13	11	10
		Flat Plate	Flat Plate	Flat Plate	Flat Plate	Flat Plate	Flat Plate	Flat Plate	Flat Plate	Flat Plate	Flat Plate
TPS-50200F		36	26	20	16	14	11	10	8	7	6
		Flat Plate	Flat Plate	Flat Plate	Flat Plate	Flat Plate	Flat Plate	Flat Plate	Flat Plate	Flat Plate	Flat Plate
TPS-50250F		36	26	20	16	13	11	9	8	7	6
		Flat Plate	Flat Plate	Flat Plate	Flat Plate	Flat Plate	Flat Plate	Flat Plate	Flat Plate	Flat Plate	Flat Plate
TPS-50300F		38	27	21	17	14	11	9	8	7	6
		Flat Plate	Flat Plate	Flat Plate	Flat Plate	Flat Plate	Flat Plate	Flat Plate	Flat Plate	Flat Plate	Flat Plate



13228 NE 20th St., Suite 100, Bellevue, WA 98005 | (425) 614-0949

Project:	B&N Industries Aluminum Extrusion Load Tables	Pg. No: B - 5
Address:	Anywhere, USA	Date: 4/16/24
Client:	B&N Industries	Job No.: 23374

FIGURE L8: HORIZONTAL LOUVERS TO VERTICAL STRINGER

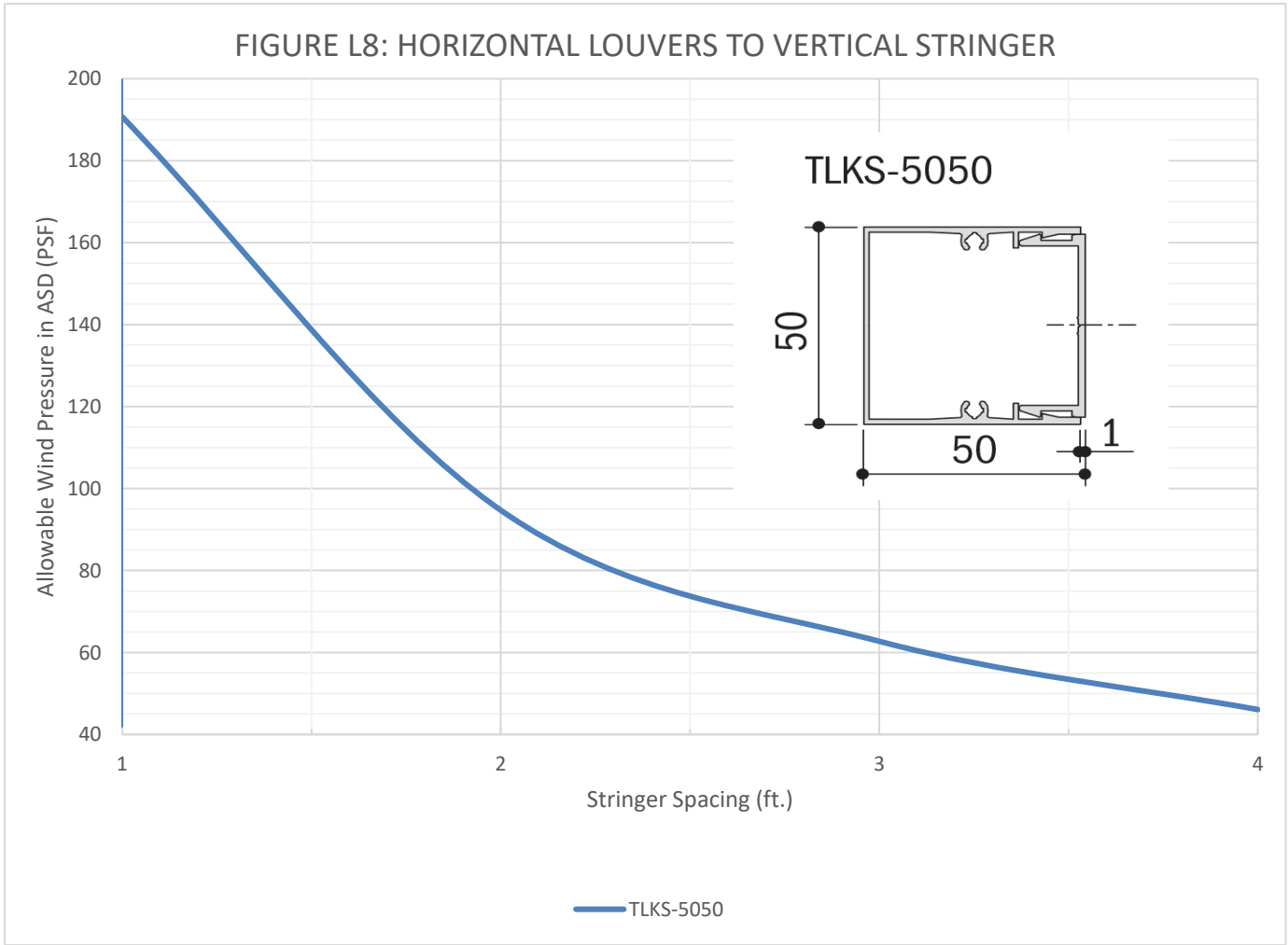
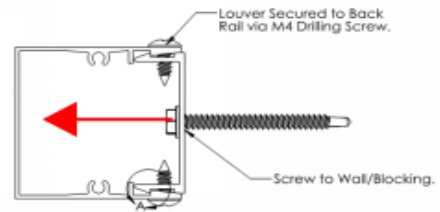

TABLE T8: HORIZONTAL LOUVERS VERTICAL STRINGER

	Stringer Spacing (ft.)	1	2	3	4
TLKS-5050	Pressure (PSF) [ASD]	191	95	63	46
		Flat Plate	Flat Plate	Flat Plate	Flat Plate
	Max Reaction Tension (lbs)	39	39	39	38
	Max Reaction Shear (lbs)	38	38	38	37



13228 NE 20th St., Suite 100, Bellevue, WA 98005 | (425) 614-0949

Project:	B&N Industries Aluminum Extrusion Load Tables	Pg. No: B - 6
Address:	Anywhere, USA	Date: 4/16/24
Client:	B&N Industries	Job No.: 23374

FIGURE L3: TRELLIS LOUVERS

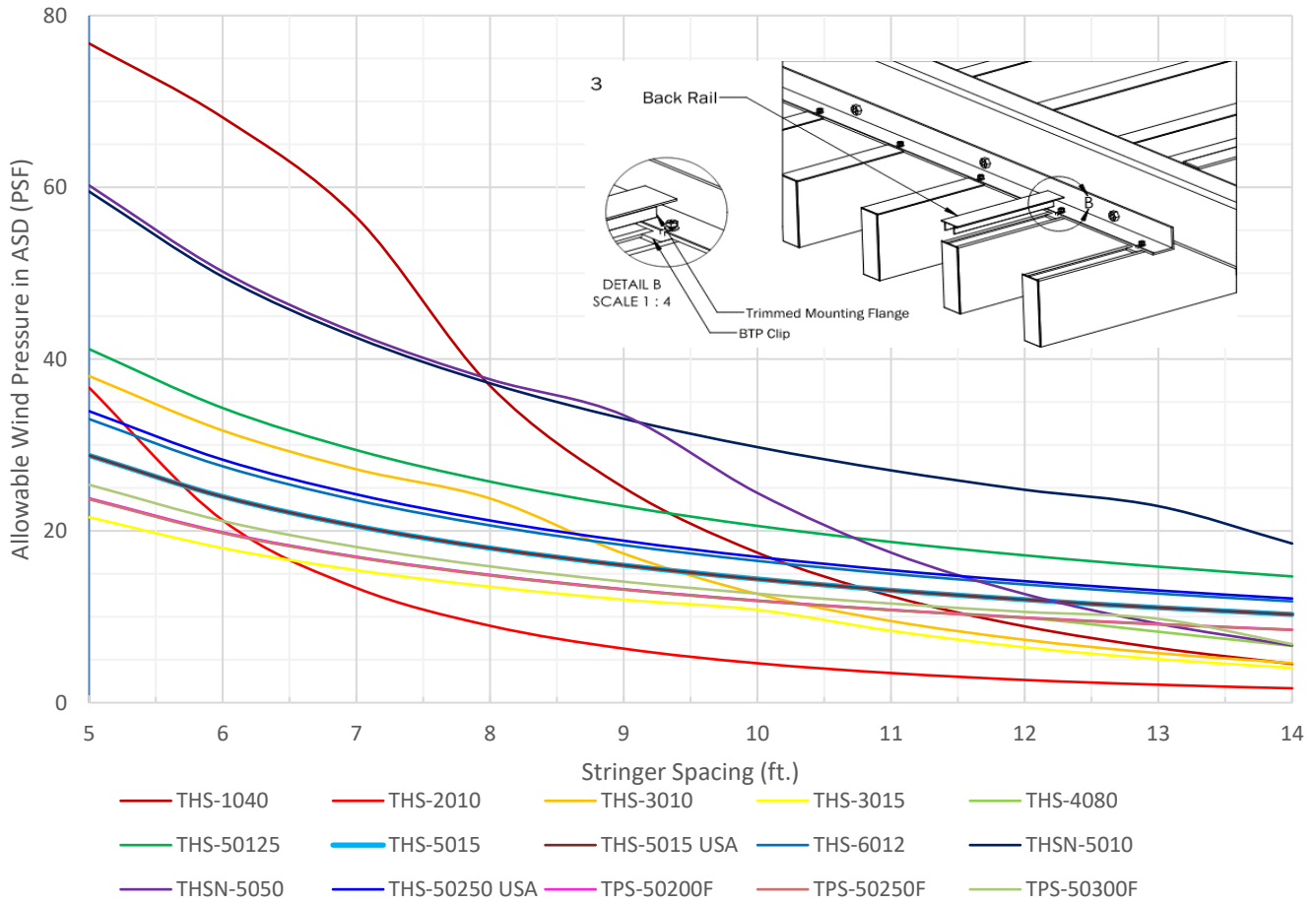

Assumptions

- This chart displays vertical extrusion installation with vertical support stringers (Assumes continuous span, min 3 bays)
 - Capacities Assume the Following
 - Vertical stringer connections back to structure at 16 " o.c.
 - Louvers spaced no closer than 3 " o.c. for all extrusions other than THS-1040 then 6 " o.c.
 - No opinion is given to capacity of connection of stringer to structure or structure capacity
 - These capacities apply to full assembly of Louvers and Stringers STAL-7, STAL-8
 - Attachment of Stringer to Structure Capacity may govern design and should be investigated.
- Capacity per connections Graphs (C-3) Tables (T-3, T-6)

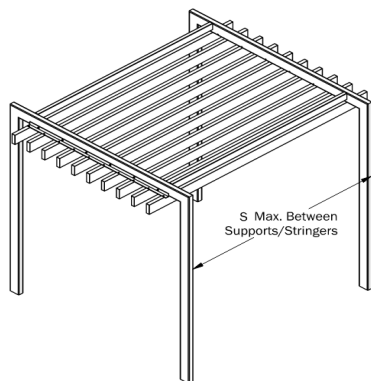

TL - Trellis Louver



13228 NE 20th St., Suite 100, Bellevue, WA 98005 | (425) 614-0949

Project:	B&N Industries Aluminum Extrusion Load Tables	Pg. No: B - 7
Address:	Anywhere, USA	Date: 4/16/24
Client:	B&N Industries	Job No.: 23374

Calculation: Tables Trellis Louver {7-9}

TABLE T3: TRELLIS LOUVERS

	Stinger Spacing (ft.)	5	6	7	8	9	10	11	12	13	14
THS-1040		77	68	57	37	25	17	12	9	6	5
	Stringer	Stringer	Deflection	Deflection	Deflection	Deflection	Deflection	Deflection	Deflection	Deflection	Deflection
THS-2010		37	21	13	9	6	5	3	3	2	2
	Deflection	Deflection	Deflection	Deflection	Deflection	Deflection	Deflection	Deflection	Deflection	Deflection	Deflection
THS-3010		38	32	27	24	17	13	10	7	6	5
	Flat Plate	Flat Plate	Flat Plate	Flat Plate	Flat Plate	Deflection	Deflection	Deflection	Deflection	Deflection	Deflection
THS-3015		22	18	15	14	12	11	8	6	5	4
	Flat Plate	Flat Plate	Flat Plate	Flat Plate	Flat Plate	Flat Plate	Flat Plate	Deflection	Deflection	Deflection	Deflection
THS-4080		24	20	17	15	13	12	11	10	8	7
	Flat Plate	Flat Plate	Flat Plate	Flat Plate	Flat Plate	Flat Plate	Flat Plate	Flat Plate	Flat Plate	Deflection	Deflection
THS-50125		41	34	29	26	23	21	19	17	16	15
	Flat Plate	Flat Plate	Flat Plate	Flat Plate	Flat Plate	Flat Plate	Flat Plate	Flat Plate	Flat Plate	Flat Plate	Flat Plate
THS-5015		29	24	21	18	16	14	13	12	11	10
	Flat Plate	Flat Plate	Flat Plate	Flat Plate	Flat Plate	Flat Plate	Flat Plate	Flat Plate	Flat Plate	Flat Plate	Flat Plate
THS-5015 USA	[ASD]	29	24	21	18	16	14	13	12	11	10
	[Failure Mode]	Flat Plate	Flat Plate	Flat Plate	Flat Plate	Flat Plate	Flat Plate	Flat Plate	Flat Plate	Flat Plate	Flat Plate
THS-6012		33	28	24	21	18	17	15	14	13	12
	Flat Plate	Flat Plate	Flat Plate	Flat Plate	Flat Plate	Flat Plate	Flat Plate	Flat Plate	Flat Plate	Flat Plate	Flat Plate
THSN-5010		60	50	43	37	33	30	27	25	23	19
	Flat Plate	Flat Plate	Flat Plate	Flat Plate	Flat Plate	Flat Plate	Flat Plate	Flat Plate	Flat Plate	Flat Plate	Deflection
THSN-5050		60	50	43	38	33	24	17	13	9	7
	Flat Plate	Flat Plate	Flat Plate	Flat Plate	Flat Plate	Flat Plate	Deflection	Deflection	Deflection	Deflection	Deflection
THS-50250 USA		34	28	24	21	19	17	15	14	13	12
	Flat Plate	Flat Plate	Flat Plate	Flat Plate	Flat Plate	Flat Plate	Flat Plate	Flat Plate	Flat Plate	Flat Plate	Flat Plate
TPS-50200F		24	20	17	15	13	12	11	10	9	8
	Flat Plate	Flat Plate	Flat Plate	Flat Plate	Flat Plate	Flat Plate	Flat Plate	Flat Plate	Flat Plate	Flat Plate	Flat Plate
TPS-50250F		24	20	17	15	13	12	11	10	9	8
	Flat Plate	Flat Plate	Flat Plate	Flat Plate	Flat Plate	Flat Plate	Flat Plate	Flat Plate	Flat Plate	Flat Plate	Flat Plate
TPS-50300F		25	21	18	16	14	13	12	11	10	7
	Flat Plate	Flat Plate	Flat Plate	Flat Plate	Flat Plate	Flat Plate	Flat Plate	Flat Plate	Flat Plate	Flat Plate	Stringer



13228 NE 20th St., Suite 100, Bellevue, WA 98005 | (425) 614-0949

Project:	B&N Industries Aluminum Extrusion Load Tables	Pg. No: B - 8
Address:	Anywhere, USA	Date: 4/16/24
Client:	B&N Industries	Job No.: 23374

FIGURE L9: TRELLIS LOUVERS

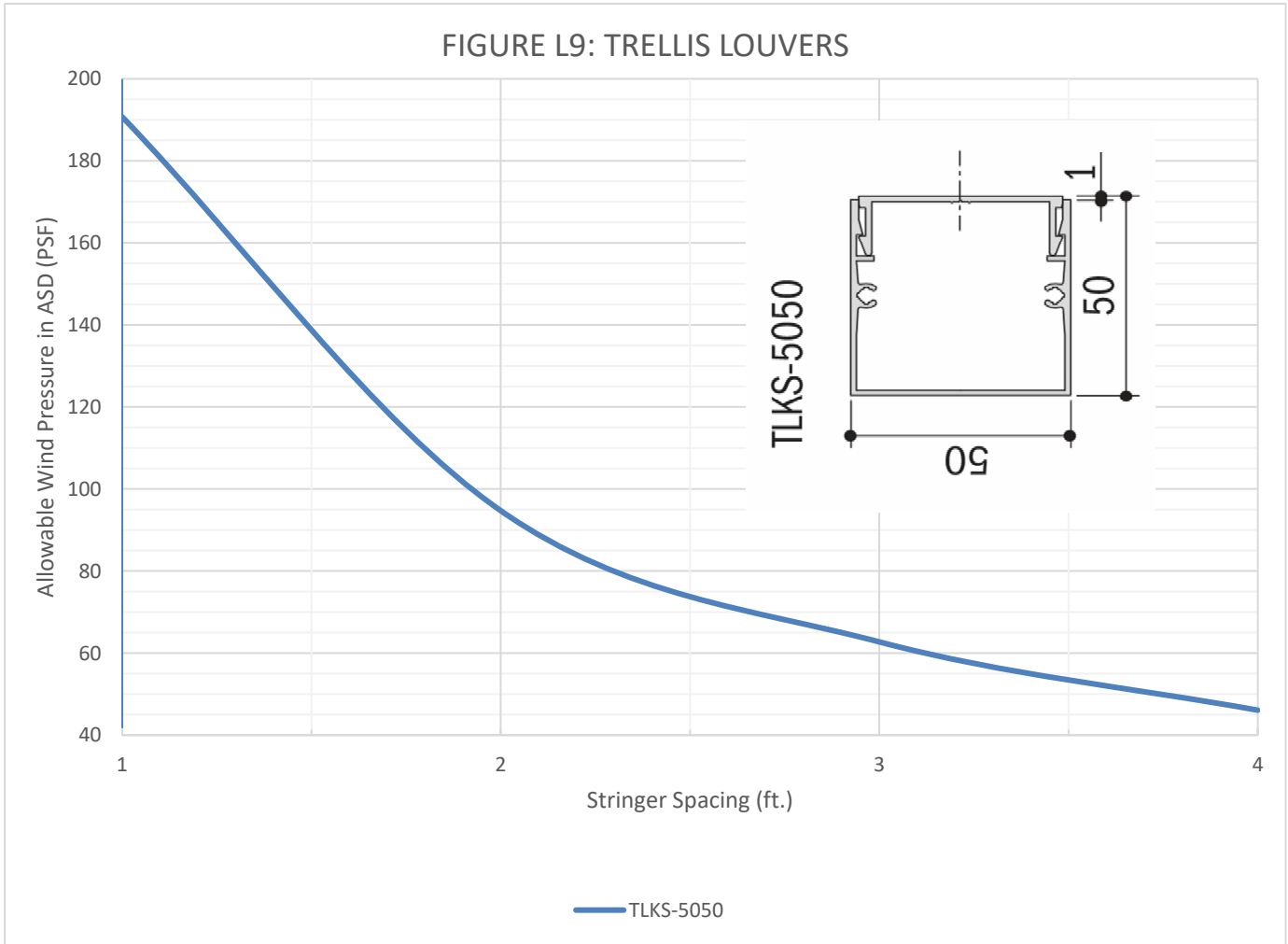
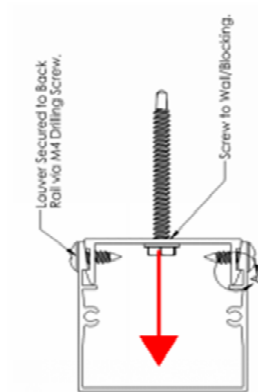

TABLE T9: TRELLIS LOUVERS

	Stringer Spacing (ft.)	1	2	3	4
TLKS-5050	Pressure (PSF) [ASD]	191	95	63	46
	Max Reaction Tension (lbs)	39	39	39	38
	Max Reaction Shear (lbs)	38	38	38	37



13228 NE 20th St., Suite 100, Bellevue, WA 98005 | (425) 614-0949

Project: B&N Industries Aluminum Extrusion Load Tables
 Address: Anywhere, USA
 Client: B&N Industries

Pg. No: B - 9
 Date: 4/16/24
 Job No.: 23374

FIGURE C1: LOUVERS CONNECTIONS LEVEL 1 (T-NUT CONNECTION)

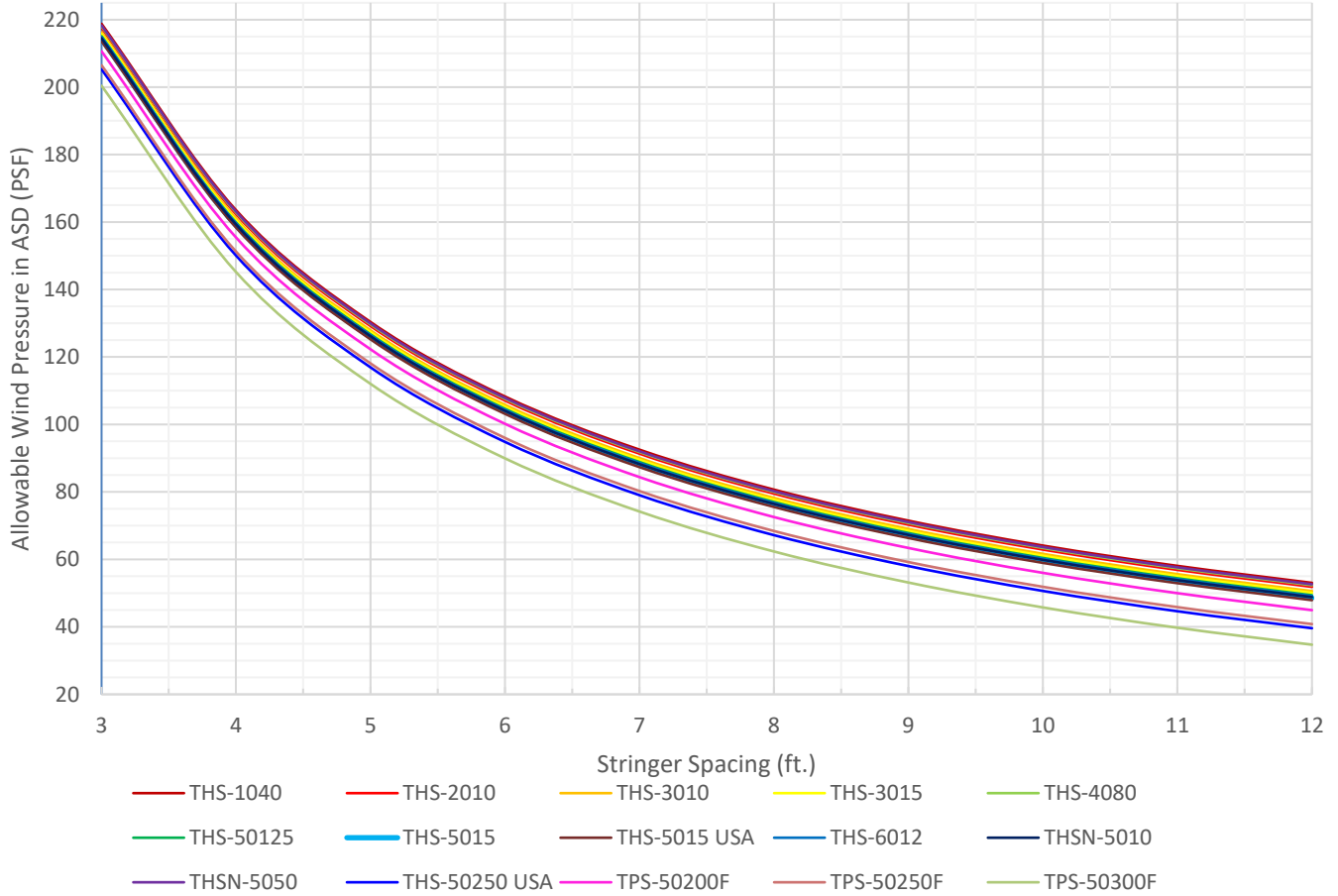

Assumptions

- This chart displays vertical extrusion installation with vertical support stringers (Assumes continuous span, min 3 bays)
- Capacities Assume the Following
 - Trellis stringer connections back to structure at 16 " o.c.
 - Louvers spaced no closer than 3 " o.c. for all extrusions other than THS-1040 then 6 " o.c.
 - No opinion is given to capacity of connection of stringer to structure or structure capacity
 - These capacities apply to connection from louvers to stringer
 - Attachement of Stringer to Structure Capacity may govern design and should be investigated. Capacity per connections table T4

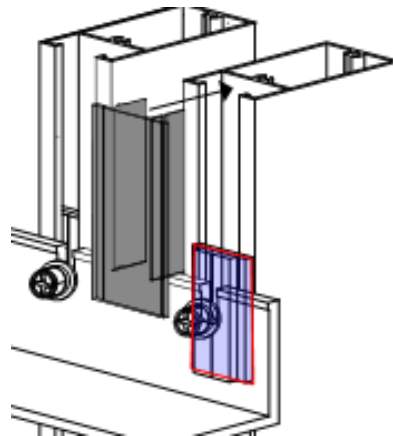

TL - Trellis Louver

13228 NE 20th St., Suite 100, Bellevue, WA 98005 | (425) 614-0949



Project:	B&N Industries Aluminum Extrusion Load Tables	Pg. No:	B - 10
Address:	Anywhere, USA	Date:	4/16/24
Client:	B&N Industries	Job No.:	23374

Calculation: Tables Connections V+H {10-12}

TABLE T4: CONNECTIONS LEVEL 1 (T-NUT CONNECTION)

	Stinger Spacing (ft.)	3	4	5	6	7	8	9	10	11	12
THS-1040	Pressure (PSF) [ASD]	219	164	130	108	93	81	71	64	58	53
THS-2010		218	162	129	107	91	80	70	63	57	52
THS-3010		216	161	128	106	90	78	69	62	56	51
THS-3015		216	161	127	105	90	78	68	61	55	50
THS-4080		218	163	130	108	92	80	71	63	57	52
THS-50125		215	160	127	105	89	77	68	60	54	49
THS-5015		214	159	126	104	88	76	67	60	54	49
THS-5015 USA		214	158	125	103	87	76	66	59	53	48
THS-6012		215	160	126	104	89	77	68	60	54	49
THSN-5010		215	159	126	104	88	76	67	60	54	49
THSN-5050		218	163	130	108	92	80	71	64	58	53
THS-50250 USA		205	150	117	95	79	67	58	51	45	40
TPS-50200F		211	155	122	100	84	73	63	56	50	45
TPS-50250F		206	151	118	96	80	68	59	52	46	41
TPS-50300F		200	145	112	90	74	62	53	46	40	35



13228 NE 20th St., Suite 100, Bellevue, WA 98005 | (425) 614-0949

Project: B&N Industries Aluminum Extrusion Load Tables
 Address: Anywhere, USA
 Client: B&N Industries

Pg. No: B - 11
 Date: 4/16/24
 Job No.: 23374

FIGURE C2: VERTICAL LOUVER CONNECTIONS LEVEL 2
(STRINGER TO BTS 5050 CLIPS)

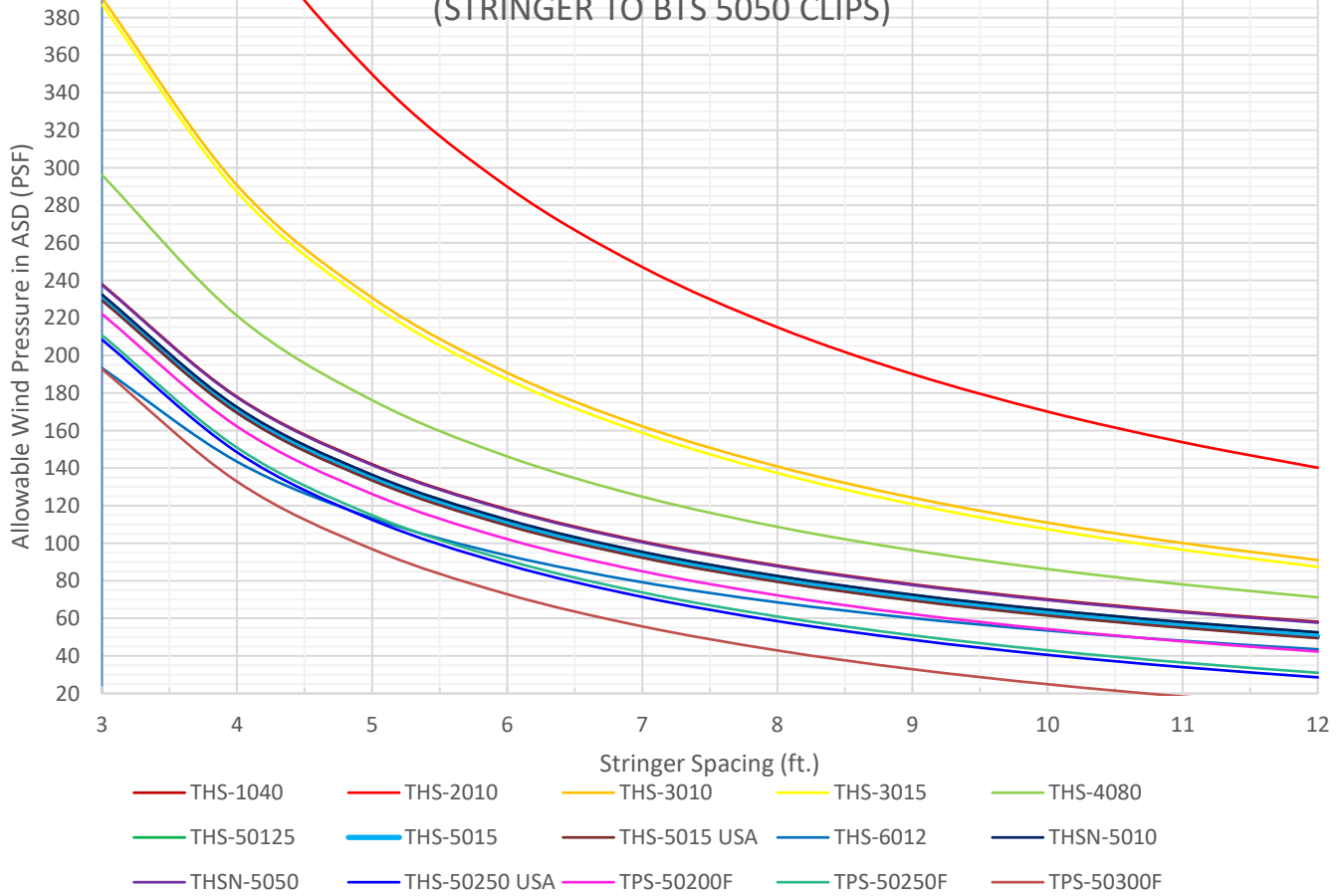

Assumptions

- This chart displays vertical extrusion installation with vertical support stringers (Assumes continuous span, min 3 bays)
- Capacities Assume the Following
 - Trellis stringer connections back to structure at 16 " o.c.
 - Louvers spaced no closer than 3 " o.c. for all extrusions other than THS-1040 then 6 " o.c.
 - No opinion is given to capacity of connection of stringer to structure or structure capacity
 - These capacities apply to connection from louvers to stringer
 - Attachment of Stringer to Structure Capacity may govern design and should be investigated. Capacity per connections table T5

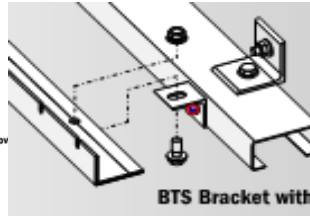
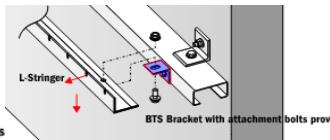
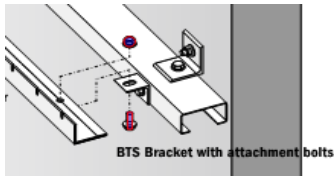

TL - Trellis Louver



13228 NE 20th St., Suite 100, Bellevue, WA 98005 | (425) 614-0949

Project:	B&N Industries Aluminum Extrusion Load Tables	Pg. No: B - 10
Address:	Anywhere, USA	Date: 4/16/24
Client:	B&N Industries	Job No.: 23374

Calculation: Tables Connections V+H {10-12}

TABLE T5: CONNECTIONS LEVEL 2 (STRINGER TO BTS 5050 CLIPS)

	Stinger Spacing (ft.)	3	4	5	6	7	8	9	10	11	12
THS-1040	Pressure (PSF) [ASD]	238	178	142	118	101	88	78	70	64	58
THS-2010		589	440	350	290	247	215	190	170	154	140
THS-3010		390	291	231	191	162	141	124	111	100	91
THS-3015		387	287	227	187	159	137	121	107	97	88
THS-4080		296	221	176	146	125	109	96	86	78	71
THS-50125		232	172	136	112	95	82	72	64	58	52
THS-5015		230	170	134	110	93	80	70	62	56	50
THS-5015 USA		229	169	133	109	92	79	69	61	55	49
THS-6012		193	143	113	93	79	69	60	54	48	44
THSN-5010		232	173	137	113	95	83	73	65	58	53
THSN-5050		238	178	142	118	101	88	78	70	63	58
THS-50250 USA		208	148	113	89	71	59	49	41	34	29
TPS-50200F		222	162	126	102	85	72	62	54	48	42
TPS-50250F		211	151	115	91	74	61	51	43	36	31
TPS-50300F		193	133	97	73	56	43	33	25	18	13



13228 NE 20th St., Suite 100, Bellevue, WA 98005 | (425) 614-0949

Project: B&N Industries Aluminum Extrusion Load Tables
 Address: Anywhere, USA
 Client: B&N Industries

Pg. No: B - 12
 Date: 4/16/24
 Job No.: 23374

FIGURE C3: TRELLIS LOUVERS

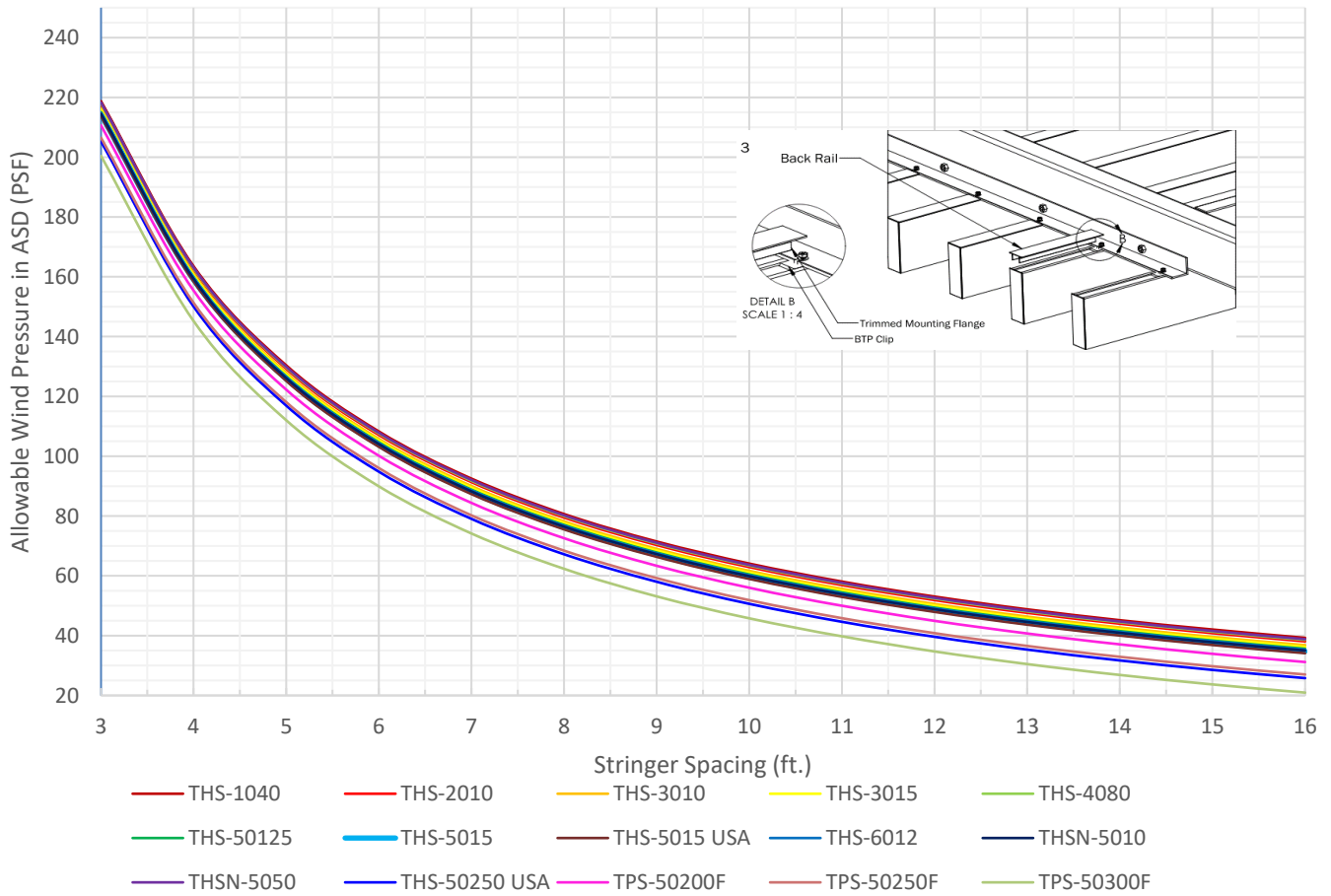

Assumptions

- This chart displays vertical extrusion installation with vertical support stringers (Assumes continuous span, min 3 bays)
- Capacities Assume the Following
 - Trellis stringer connections back to structure at 16 " o.c.
 - Louvers spaced no closer than 3 " o.c. for all extrusions other than THS-1040 then 6 " o.c.
 - No opinion is given to capacity of connection of stringer to structure or structure capacity
 - These capacities apply to connection from louvers to stringer
 - Attachment of Stringer to Structure Capacity may govern design and should be investigated. Capacity per connections table T6

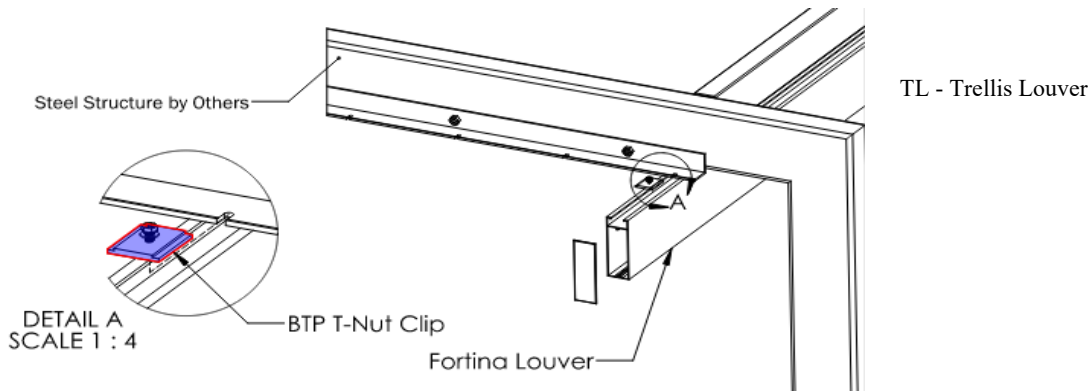

13228 NE 20th St., Suite 100, Bellevue, WA 98005 | (425) 614-0949

Project:	B&N Industries Aluminum Extrusion Load Tables	Pg. No:	B - 13
Address:	Anywhere, USA	Date:	4/16/24
Client:	B&N Industries	Job No.:	23374

Calculation: Tables Connections Trellis {13-
TABLE T6: CONNECTIONS TRELLIS (T-NUT CONNECTION)

	Stinger Spacing (ft.)	3	4	5	6	7	8	9	10	11	12	13	14	15	16
THS-1040	Pressure (PSF) [ASD]	219	164	130	108	93	81	71	64	58	53	49	45	42	39
THS-2010		218	162	129	107	91	80	70	63	57	52	48	44	41	38
THS-3010		216	161	128	106	90	78	69	62	56	51	46	43	40	37
THS-3015		216	161	127	105	90	78	68	61	55	50	46	42	39	36
THS-4080		218	163	130	108	92	80	71	63	57	52	48	44	41	39
THS-50125		215	160	127	105	89	77	68	60	54	49	45	42	38	36
THS-5015		214	159	126	104	88	76	67	60	54	49	44	41	38	35
THS-5015 USA		214	158	125	103	87	76	66	59	53	48	44	40	37	34
THS-6012		215	160	126	104	89	77	68	60	54	49	45	41	38	35
THSN-5010		215	159	126	104	88	76	67	60	54	49	45	41	38	35
THSN-5050		218	163	130	108	92	80	71	64	58	53	48	45	42	39
THS-50250 USA		205	150	117	95	79	67	58	51	45	40	35	32	29	26
TPS-50200F		211	155	122	100	84	73	63	56	50	45	41	37	34	31
TPS-50250F		206	151	118	96	80	68	59	52	46	41	37	33	30	27
TPS-50300F		200	145	112	90	74	62	53	46	40	35	30	27	24	21



13228 NE 20th St., Suite 100, Bellevue, WA 98005 | (425) 614-0949

Project:	B&N Industries Aluminum Extrusion Load Tables	Pg. No: B - 14
Address:	Anywhere, USA	Date: 4/16/24
Client:	B&N Industries	Job No.: 23374